

**Joker**

A	Description	Circuit	H <sub>2</sub>	12V fridge heating element	19	S <sub>8</sub>	1 pin connector; tank water level sensor
A <sub>1</sub>	battery charger; bench seat	5, 6	H <sub>3</sub>	gas de-icer heating element	33	S <sub>9</sub>	1 pin connector; fresh water tank
B	connection to the switch box; VW schematic	11, 12, 13	J <sub>1</sub>	220V fridge switch	6, 7	S <sub>10</sub>	2 pin connector; tap outlet
C <sub>1</sub>	secondary battery isolation relay; driver's seat box	10, 11, 12, 13	J <sub>2</sub>	220V fridge thermostat	7	S <sub>11</sub>	2 pin connector; water pump
C <sub>2</sub>	isolationrelay; 12V fridge	20, 21	J <sub>3</sub>	12V fridge switch	20	S <sub>12</sub>	3 pin connectors; strip lights
D <sub>1</sub>	auxiliary heating (B2L/D2L)	16, 17	J <sub>4</sub>	fridge thermostat switch	22	S <sub>13</sub>	
E <sub>1</sub>	25A fuse (heating); on B pillar	14	J <sub>5</sub>	control panel switch	26	S <sub>14</sub>	4 pin connectors; strip lights
E <sub>2</sub>	16A fuse (fridge/pump)	13	J <sub>6</sub>	gas de-icer switch	29	S <sub>15</sub>	
E <sub>3</sub>	10mA automatic trip switch (residual current circuit breaker)	1, 2, 3	J <sub>7</sub>	water pump switch; tap outlet	35		
E <sub>4</sub>	1A filament fuse; control panel	26	J <sub>8</sub>	integrated light switches	38 - 47		
E <sub>5</sub>	2A filament fuse; battery charger	5, 6	J <sub>13</sub>			①	left side wall earth point
F	cab interior lights	36, 38, 44, 45	K <sub>1</sub>	220V external plug	1, 2, 3	②	right side earth point
F <sub>1</sub>	strip lights	38, 40, 41, 45,	K <sub>2</sub>	220V internal socket	1, 2, 3	③	driver's seat battery box earth point
F <sub>4</sub>		46, 49	K <sub>3</sub>	220V internal socket for fridge	4, 5, 6	④	left side wall earth point
F <sub>5</sub> , F <sub>6</sub>	downlights	48	L	tank water level sensor; fresh water tank			
G <sub>1</sub>	fridge fan	22	S <sub>1</sub>	2 pin connector; charger			
G <sub>2</sub>	water pump	35	S <sub>2</sub>	3 pin connector; charger			
H <sub>1</sub>	220V fridge heating element	5	S <sub>3</sub>	2 pin connector; auxiliary heating			
			S <sub>4</sub>	3 pin connector; fridge			
			S <sub>5</sub>	1 pin connector; fridge			
			S <sub>6</sub>	6 pin connector; control panel			
			S <sub>7</sub>	2 pin connector; gas de-icer			

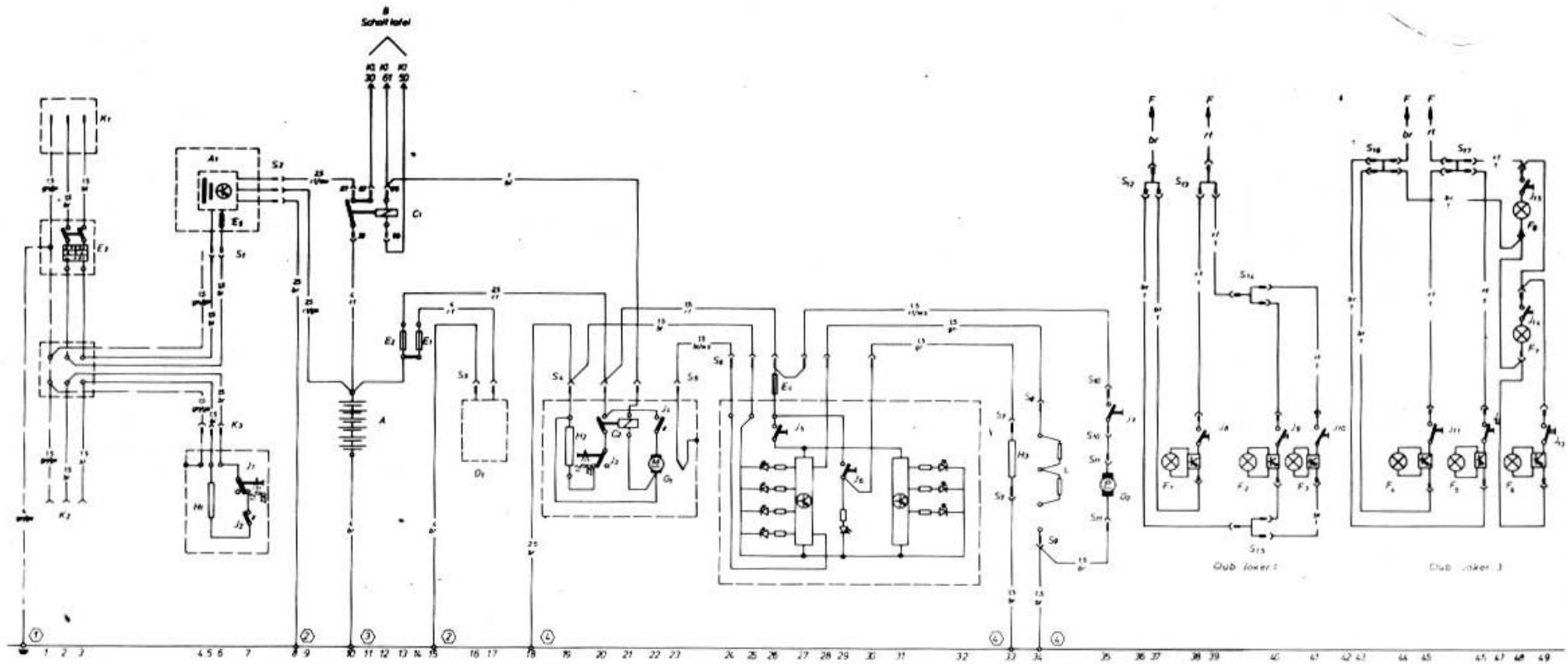

### Club Joker

Description	Circuit	H <sub>1</sub>	H <sub>2</sub>	H <sub>3</sub>	J <sub>1</sub>	J <sub>2</sub>	J <sub>3</sub>	J <sub>4</sub>	J <sub>5</sub>	J <sub>6</sub>	J <sub>7</sub>	J <sub>8</sub>	J <sub>15</sub>	K <sub>1</sub>	K <sub>2</sub>	K <sub>3</sub>	L	S <sub>1</sub>	S <sub>2</sub>	S <sub>3</sub>	S <sub>4</sub>	S <sub>5</sub>	S <sub>6</sub>	S <sub>7</sub>	S <sub>8</sub>	S <sub>9</sub>	S <sub>10</sub>	S <sub>11</sub>	S <sub>12</sub>	S <sub>15</sub>	S <sub>16</sub> ,	S <sub>17</sub>		
A	12V secondary battery; driver's seat box	10																																
A <sub>1</sub>	battery charger; bench seat	5, 6																																
B	connection to the switch box; VW schematic	11, 12, 13																																
C <sub>1</sub>	secondary battery isolation relay; driver's seat box	10, 11, 12, 13																																
C <sub>2</sub>	isolation relay; 12V fridge	20, 21																																
D <sub>1</sub>	auxiliary heating (B2L/D2L)	16, 17																																
E <sub>1</sub>	25A fuse (heating); on B pillar	14																																
E <sub>2</sub>	16A fuse (fridge/pump)	13																																
E <sub>3</sub>	10mA automatic trip switch (residual current circuit breaker)	1, 2, 3																																
E <sub>4</sub>	1A filament fuse; control panel	26																																
E <sub>5</sub>	2A filament fuse; battery charger	5, 6																																
F	cab interior lights	36, 38, 44, 45																																
F <sub>1</sub>	strip lights	38, 40, 41, 45,																																
F <sub>6</sub>		46, 49																																
F <sub>7</sub>	downlights	48																																
F <sub>8</sub>																																		
G <sub>1</sub>	fridge fan	22																																
G <sub>2</sub>	water pump	35																																

- ① left side wall earth point
- ② right side wall earth point
- ③ driver's seat battery box earth point
- ④ left side wall earth point

2162.8

Ausgabe 8/85

Westfalia-Werke Franz Knöbel und Söhne KG · 4840 Rheda-Wiedenbrück